



## Yuasa Fiche de données techniques

### Yuasa YB12A-A - YuMicron Batterie

#### Performance

|                      |        |
|----------------------|--------|
| Tension              | 12V    |
| Capacité (10heures)  | 12Ah   |
| Capacité (20 heures) | 12.6Ah |
| CCA à -18°C          | 150A   |

#### Dimensions (±2mm)

|          |       |
|----------|-------|
| Longueur | 134mm |
| Largeur  | 80mm  |
| Hauteur  | 160mm |

#### Poids & Mesures

|                        |       |
|------------------------|-------|
| Poids moyen avec acide | 4.1kg |
| Volume d'acide         | 0.8l  |

#### Technologie

|             |                             |
|-------------|-----------------------------|
| Technologie | Moulé Sb/Sb                 |
| Séparateur  | Synthetic Resin+Glass Fiber |



#### Schéma de montage des éléments

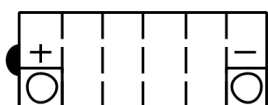

#### Type de bornes - 6

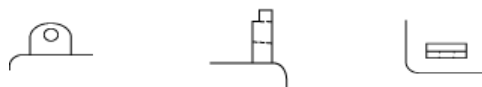

Date de publication: 27/11/2021 - E&OE



## Yuasa Technical Data Sheet

### Yuasa YB12A-A - YuMicron Battery

#### Performance

|                    |        |
|--------------------|--------|
| Voltage            | 12V    |
| Capacity (10-hour) | 12Ah   |
| Capacity (20-hour) | 12.6Ah |
| CCA @ -18°C        | 150A   |

#### Dimensions (±2mm)

|        |       |
|--------|-------|
| Length | 134mm |
| Width  | 80mm  |
| Height | 160mm |

#### Weights & Measures

|                       |       |
|-----------------------|-------|
| Mean Weight with Acid | 4.1kg |
| Acid Volume           | 0.8l  |

#### Technology

|            |                             |
|------------|-----------------------------|
| Technology | Cast Sb/Sb                  |
| Separator  | Synthetic Resin+Glass Fiber |



#### Cell Assembly Layout

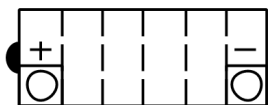

#### Terminal Type - 6

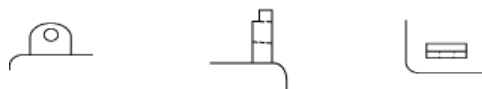

Data Sheet generated on 27/11/2021 - E&OE