



Yuasa Fiche de données techniques

Yuasa YB10L-BP - YuMicron Batterie

Performance

Tension	12
Capacité (10heures)	12Ah
Capacité (20 heures)	12.6Ah
CCA à -18°C	165A

Dimensions (±2mm)

Longueur	135mm
Largeur	90mm
Hauteur	145mm

Poids & Mesures

Poids moyen avec acide	4kg
Volume d'acide	0.8l

Technologie

Technologie	Moulé Sb/Sb
Séparateur	Leaf



Schéma de montage des éléments

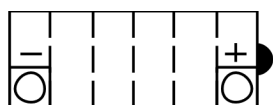

Type de bornes - 6

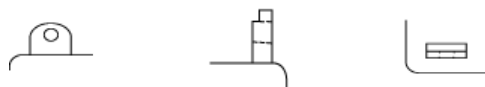

Date de publication: 31/01/2023 - E&OE



Yuasa Technical Data Sheet

Yuasa YB10L-BP - YuMicron Battery

Performance

Voltage	12
Capacity (10-hour)	12Ah
Capacity (20-hour)	12.6Ah
CCA @ -18°C	165A

Dimensions (±2mm)

Length	135mm
Width	90mm
Height	145mm

Weights & Measures

Mean Weight with Acid	4kg
Acid Volume	0.8l

Technology

Technology	Cast Sb/Sb
Separator	Leaf



Cell Assembly Layout

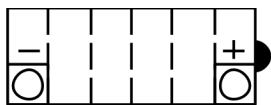

Terminal Type - 6

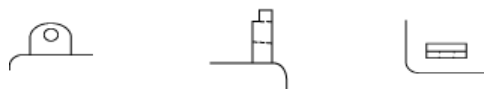

Data Sheet generated on 31/01/2023 - E&OE