



Yuasa Fiche de données techniques

Yuasa YB10L-B - YuMicron Batterie

Performance

Tension	12
Capacité (10heures)	11Ah
Capacité (20 heures)	11.6Ah
CCA à -18°C	120A

Dimensions (±2mm)

Longueur	135mm
Largeur	90mm
Hauteur	145mm

Poids & Mesures

Poids moyen avec acide	4kg
Volume d'acide	0.8l

Technologie

Technologie	Moulé Sb/Sb
Séparateur	Synthetic Resin+Glass Fiber



Schéma de montage des éléments



Type de bornes - 6

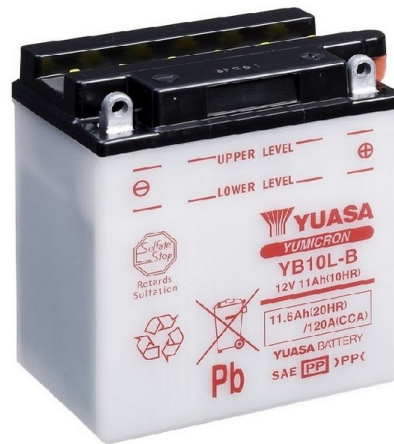
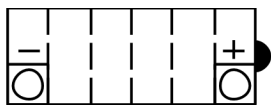
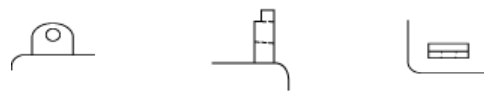

Date de publication: 01/10/2023 - E&OE



Yuasa Technical Data Sheet

Yuasa YB10L-B - YuMicron Battery

Performance

Voltage	12
Capacity (10-hour)	11Ah
Capacity (20-hour)	11.6Ah
CCA @ -18°C	120A

Dimensions ($\pm 2\text{mm}$)

Length	135mm
Width	90mm
Height	145mm

Weights & Measures

Mean Weight with Acid	4kg
Acid Volume	0.8l

Technology

Technology	Cast Sb/Sb
Separator	Synthetic Resin+Glass Fiber

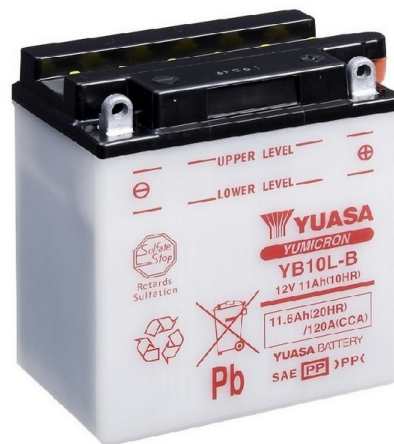

Cell Assembly Layout

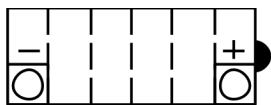

Terminal Type - 6

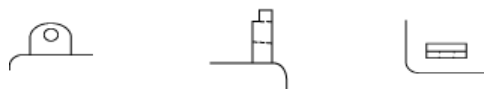

Data Sheet generated on 01/10/2023 - E&OE