



Yuasa Fiche de données techniques

Yuasa 12N7D-3B - Conventionnelle 12V Batterie

Performance

Tension	12
Capacité (10heures)	7Ah
Capacité (20 heures)	7.4Ah
CCA à -18°C	70A

Dimensions (±2mm)

Longueur	135mm
Largeur	75mm
Hauteur	150mm

Poids & Mesures

Poids moyen avec acide	2.9kg
Volume d'acide	0.6l



Technologie

Technologie	Moulé Sb/Sb
Séparateur	Reinforcing fiber+Glass Fiber

Schéma de montage des éléments

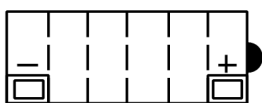

Type de bornes - 6

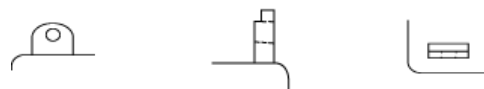

Date de publication: 22/03/2023 - E&OE



Yuasa Technical Data Sheet

Yuasa 12N7D-3B - Conventional 12 Volt Battery

Performance

Voltage	12
Capacity (10-hour)	7Ah
Capacity (20-hour)	7.4Ah
CCA @ -18°C	70A

Dimensions (±2mm)

Length	135mm
Width	75mm
Height	150mm

Weights & Measures

Mean Weight with Acid	2.9kg
Acid Volume	0.6l



Technology

Technology	Cast Sb/Sb
Separator	Reinforcing fiber+Glass Fiber

Cell Assembly Layout

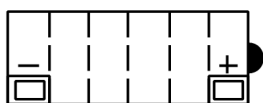

Terminal Type - 6

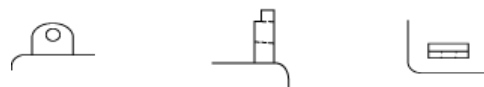

Data Sheet generated on 22/03/2023 - E&OE